

# DEL/DRIVE® 50



**“THE IDEAL ALTERNATIVE TO MODULAR BELTS”**

	DEL/DRIVE® 50	DEL/DRIVE® 50	DEL/DRIVE® 50EM	DEL/DRIVE® 50EM	DEL/DRIVE® 50H
Reference	<b>DDB50B3</b>	<b>DDB50B5</b>	<b>DDB50W3</b>	<b>DDB50B3EM</b>	<b>DDB50B3H</b>
Material	Polyurethane	Polyurethane	Polyurethane	Polyurethane	Polyester elastomer
Colour	Blue	Blue	White	Blue	Blue
Food	CE / FDA	CE / FDA	CE / FDA	CE / FDA	CE / FDA
Top surface	Smooth	Smooth	Embossed	Embossed	Smooth
Hardness	95 ShA	95 ShA	95 ShA	95 ShA	55 ShD
Pitch +/- 0.3 (mm)	50	50	50	50	49.5
Thickness (mm)	3	5	3	3	3
Overall thickness (mm)	8.6	10.6	8.6	8.6	8.3
Maximum width (mm)	1 800	1 800	1 800	1 800	1 800*
Weights	4.8 kg/m <sup>2</sup>	7.3 kg/m <sup>2</sup>	4.8 kg/m <sup>2</sup>	4.8 kg/m <sup>2</sup>	4.4 kg/m <sup>2</sup>
Min. pulley diameter (mm)	95	95	95	95	128
Min. pulley diameter - back flex (mm)	100	100	100	100	150
Temperature range	-20°C to +60°C	-20°C to +60°C	-20°C to +60°C	-20°C to +60°C	-20°C to +80°C
Traction force at 2,5% elongation for 100 mm width	65 daN	65 daN	65 daN	65 daN	160 daN
<b>Friction coefficient</b>					
On HDPE bed	0.2	0.2	0.2	0.2	0.15
On stainless steel bed	0.52	0.52	0.52	0.52	0.45

\* For any width > 1200mm, please contact us

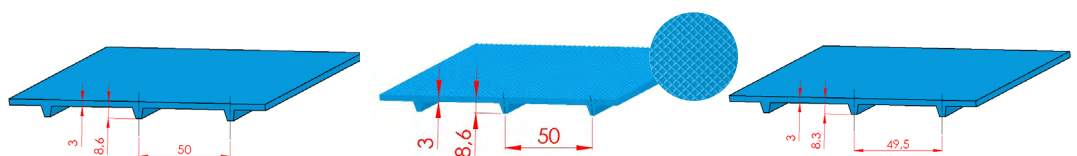

# DEL/DRIVE® 50

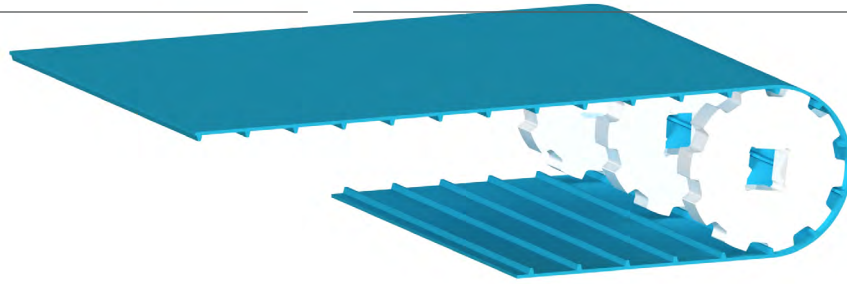

DEL/DRIVE® 50EMLT	DEL/DRIVE® 50AM	DEL/DRIVE® 50AMEM	DEL/DRIVE® 50MD	DEL/DRIVE® 50-25
<b>DDB50B3EMLT</b>	<b>DDB50B3AM</b>	<b>DDB50B3AMEM</b>	<b>DDB50B3MD</b>	<b>DDB50-25B12</b>
Polyurethane	Polyurethane	Polyurethane	Polyurethane Metal Detectable	Polyurethane
Blue	Dark blue	Dark blue	Dark blue	Blue
CE / FDA	CE / FDA	CE / FDA	CE	CE / FDA
Embossed	Smooth	Embossed	Smooth	With teeth
92 ShA	95 ShA	95 ShA	95 ShA	95 ShA
50	50	50	50	50
3	3	3	3	3
8.6	8.6	8.6	8,6	12
1800	1 800	1 800	1800	1 800
4.8 kg/m <sup>2</sup>	4.8 kg/m <sup>2</sup>	4.8 kg/m <sup>2</sup>	4,8 kg/m <sup>2</sup>	4.8 kg/m <sup>2</sup>
95	95	95	95	95
80	100	100	100	100
-30°C to +50°C	-20°C to +60°C	-20°C to +60°C	-20°C to +60°C	-20°C to +60°C
35 daN	65 daN	65 daN	65 daN	65 daN
0.25	0.2	0.2	0,2	0.2
0.6	0.52	0.52	0,52	0.52

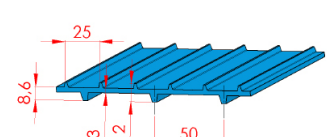
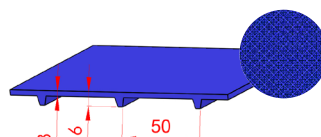
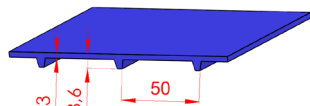
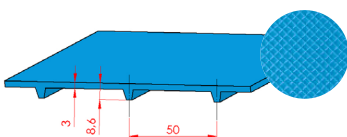

# DEL/DRIVE® 50



The DEL/DRIVE® positive drive belt meets the **most stringent standards of hygiene** and is **the ideal alternative to conventional modular belts**. It replaces a modular belt without any modifications. It is either driven on a sprocket or a motorized drum.

The DEL/DRIVE® belt is installed **without tension**, thereby reducing stress on the conveyor's mechanical components: shafts, anti-friction bearings, roller bearing, etc.

DEL/DRIVE® can be configured with flights, sidewalls or other profiles.

The DEL/DRIVE® comes in several versions to meet all needs:

**The DEL/DRIVE® 50** belt in polyurethane is both flexible and has high tensile strength. It is the ideal solution for the conveyance of light to medium-weight loads. The DEL/DRIVE® 50 is available in blue or white.

**The DEL/DRIVE® 50EM** belt is a variant of the DEL/DRIVE® 50 belt with a structured top side for improved transport of frozen products.

**The DEL/DRIVE® 50H** belt in polyester elastomer is recommended for medium to heavy loads and can be used with long centre-to-centre distances. In certain cases, its high tensile strength and low friction coefficient permits accumulation of transported products. It can withstand higher peak temperatures, depending on the load.

**The DEL/DRIVE® 50EMLT** belt is specially designed to operate in very low ambient temperatures. Its embossed top surface facilitates the conveyance of frozen products.

**The DEL/DRIVE® 50AM** belt has the same characteristics as the DEL/DRIVE® 50 belt plus an infused antimicrobial treatment. DEL/DRIVE® 50AM improves food safety by inhibiting the proliferation of bacteria.

This prevents the contamination of transported products.  
A further benefit is the reduction of odours and cleaning cycles.

**The DEL/DRIVE® 50AMEM** belt has an infused antimicrobial treatment and an embossed top surface that reduces adherence of the products on the belt.

**The DEL/DRIVE® 50-25** belt has 50mm drive teeth on one face, and 25mm drive teeth on the other allowing one side to drive and the other to act as low flights for increased grip.

# DEL/DRIVE® 50

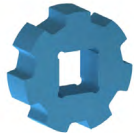

## SPROCKETS AND IDLER WHEELS



REFERENCE	PRODUCT	MATERIAL	COLOUR	OUTER DIAMETER (mm)	NUMBER OF TEETH	SQUARE BORE (mm)	WIDTH (mm)
P50BUN06	Sprocket	HDPE	Blue	95	6	40	32
R50BUN06	Wheel	HDPE	Blue	83	-	40	32
P50BUN08	Sprocket	HDPE	Blue	128	8	40	32
R50BUN08	Wheel	HDPE	Blue	116	-	40	32
P50BUN10	Sprocket	HDPE	Blue	161	10	40	32
R50BUN10	Wheel	HDPE	Blue	149	-	40	32
P50BUN12	Sprocket	HDPE	Blue	193	12	40	32
R50BUN12	Wheel	HDPE	Blue	181	-	40	32

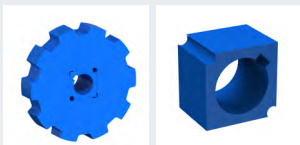

The standard sprockets we offer have a square bore for a 40x40 mm drive shaft.

**They can be mounted on other shafts with special adapters.**  
Please enquire for any other dimensions of round or square shaft.

## SPROCKETS FOR DRIVING DRUM

HDPE sprockets on stainless steel ring, locked with set screw.

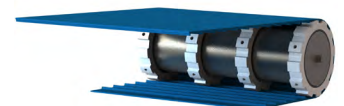

REFERENCE	MATERIAL	COLOUR	OUTER DIAMETER (mm)	NUMBER OF TEETH	DRUM MOTOR		WIDTH (mm)
P50BUN09R122	HDPE	Blue	144	9	113i	DM0113	34
P50BUN12R147	HDPE	Blue	193	12	138i	DM0138	34
P50BUN14R174	HDPE	Blue	225	14	165i	DM0165	34

## DRIVING DRUM WITH PROFILED POLYURETHANE LINING

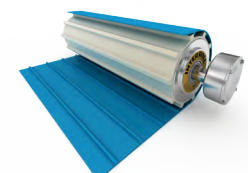

DRIVING DRUM	80i	113i	138i	165i
NUMBER OF TEETH	-	9	10	12
OUTSIDE DIAMETER PACKING (MM) (+0,5 ; -1)	-	142,5	158	190,2

# DEL/DRIVE® 25



«**POSITIVE DRIVE ON SMALL PULLEY DIAMETERS**»

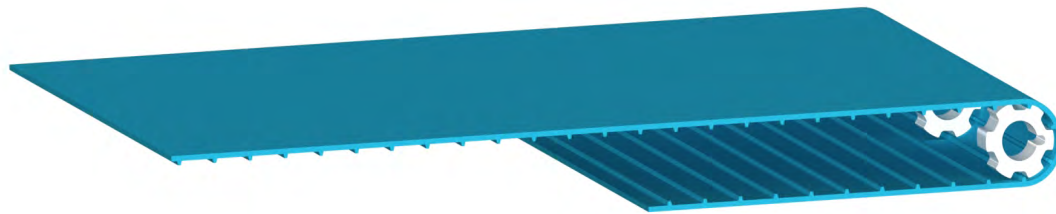

## DEL/DRIVE® 25

	DDB25B2	DDB25B2.8	DDB25B2.8EM
Reference	DDB25B2	DDB25B2.8	DDB25B2.8EM
Material	Polyurethane	Polyurethane	Polyurethane
Colour	Blue	Blue	Blue
Food	CE / FDA	CE / FDA	CE / FDA
Top surface	<b>Smooth</b>	<b>Smooth</b>	<b>Embossed</b>
Hardness	93 ShA	93 ShA	93 ShA
Pitch (mm)	25.3	25.3	25.3
Thickness (mm)	2	2,8	2,8
Overall thickness (mm)	6	7	7
Max. width (mm)	<b>1 800</b>	<b>1 800</b>	<b>1 800</b>
Weights	3 kg/m <sup>2</sup>	4 kg/m <sup>2</sup>	4 kg/m <sup>2</sup>
Min. pulley diameter (mm)	48	56,7	56,7
Min. pulley diameter - back flex (mm)	50	60	60
Temperature range	-20°C / +60°C		
Traction force at 2% elongation	25 daN for a width of 100 mm	30 daN for a width of 100 mm	30 daN for a width of 100 mm
<b>Friction coefficient</b>			
On HDPE bed	0,22		
On stainless steel bed	0,55		

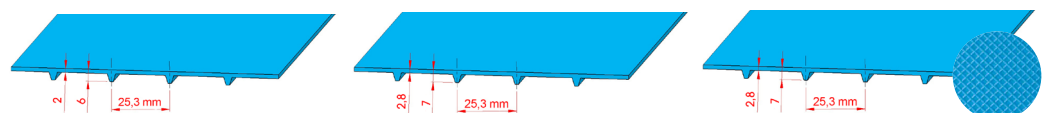



# DEL/DRIVE® 25

The DEL/DRIVE® 25 belt is flexible, light with a small pitch and thickness for smaller diameter sprockets. It thus reduces the space requirements of conveyors and facilitates the transfer of transported products.



## DRIVE SPROCKETS



REFERENCE	MATERIAL	COLOUR	OUTER DIAMETER (mm)	NUMBER OF TEETH	BORE (mm)		WIDTH (mm)
					square	∅ round	
P25BUN06R25	HDPE	Blue	48	6	-	25	25
P25BUN07R25	HDPE	Blue	56,7	7	-	25	25
P25BUN08R25	HDPE	Blue	65	8	-	25	25
P25BUN10C40	HDPE	Blue	81	10	40	-	25
P25BUN12C40	HDPE	Blue	97,5	12	40	-	25

## DRIVING DRUM WITH PROFILED

DRIVING DRUM	DM0080 80i	DM0113 113i	DM0138 138i
NUMBER OF TEETH	13	18	20
OUTSIDE DIAMETER PACKING (MM) (+0,5 ; -1)	104,2	144,3	161,5

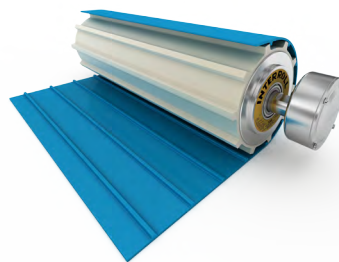

For the return of the DEL/DRIVE® 25 belt, we recommend a running roller with a larger diameter rather than the recommended minimum diameter.