

LOW FRICTION GUIDES FOR ROUND PROFILES

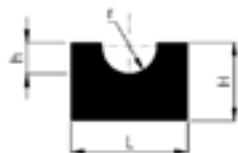

Made of High Density Polyethylene (HDPE), the VIT/GLISS slides offer, in addition to good guidance, an excellent friction coefficient that increases the load carrying capacity of the belts.



Type	Ref.	∅ Profiles	L	H	r	h
R6	GR06	∅ 6	20	10	4	4
R8	GR08	∅ 8	20	12	5	5
R10	GR10	∅ 9.5 - 10	25	15	6	6
R12	GR12	∅ 12 - 12.5	30	20	7	8
R15	GR15	∅ 15	35	25	8.5	10
R18	GR18	∅ 18	40	25	10	12

Delivered in 3m lengths.

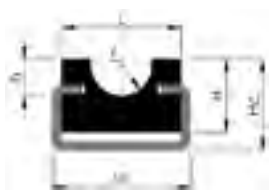

Type	Ref.	∅ Profiles	L	H	r	h	Hc	Lc	Hr	e	Lr
RC6	GRC06	∅ 6	20	15	4	4	18	20	10	1.5	10
RC8	GRC08	∅ 8	20	15	5	5	18	20	10	1.5	10
RC10	GRC10	∅ 9.5 - 10	20	15	6	6	20	20	10	1.5	10
RC12	GRC12	∅ 12 - 12.5	28	15	7	8	20	28	12	2	14
RC15	GRC15	∅ 15	33	20	8.5	10	25	38	18	2.5	22
RC18	GRC18	∅ 18	38	20	10	12	25	38	18	2.5	22

Delivered in 3m lengths.

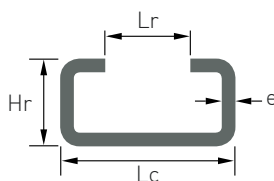

- Galvanized steel rail.
- Option of white or food blue HDPE slide on stainless steel rail.
- Custom slides available.

Consult us.

Benefits:

- Perfect belt guidance.
- Low coefficient of friction.
- Excellent abrasion resistance.
- Good shock resistance.
- Good resistance to corrosion and most chemical agents.
- Maximum continuous operating temperature: 70°C.
- Temperature extremes at peak speeds: -40°C to 100°C.

CAUTION

When fitting, consider the HDPE's thermal expansion, which is 2 mm per metre for every 10°C of temperature rise.

RADIUSSED ROUND BELT SLIDES



GR12CO25x16 GR12CO20x20 GR12CO20x20N

The flexibility of this slide allows it to be installed in a curve allowing the belt to change direction.

3 standard models for round profiles - 12 mm:
25 x 16 mm and 20 x 20 mm with or without positioning groove.

Recommended profiles: POLY/FLEX rough or other deglazed profile.

